

3701

B.Tech. (Civil Engg.) 8th Semester (G-Scheme)

Examination, July-2022

ESTIMATION COSTING AND VALUATION

Paper- PCC-CE-402-G

Time allowed : 3 hours]

[Maximum marks : 75

Before answering the questions, candidate should ensure that they have been supplied the correct and complete question paper. No complaint in this regard, will be entertained after examination.

***Note:** Attempt five questions in all, selecting one-question from each section. Question no. 1 is compulsory. All question carry equal marks.*

1. Describe the following:

15

- (a) Necessity of specification
- (b) Traditional material
- (c) Purpose of Abstract
- (d) Earnest Money
- (e) Gross Income
- (f) Purpose of Estimating

Section-A

2. (a) What do you mean by estimation and also explain different method of estimation. 7

(b) Explain different types of estimation. 8

(2)

3701

3. Estimate the quantity by the long and short wall method of the following figure. 15

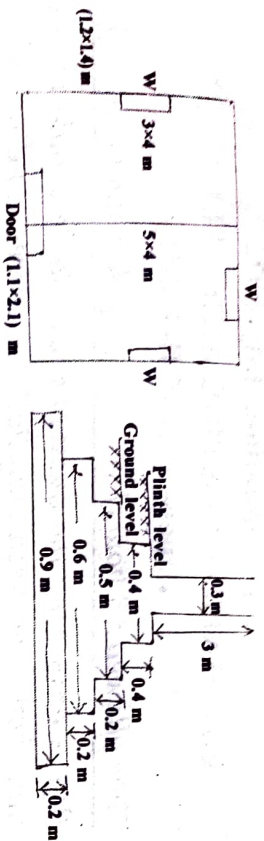

Section-B

4. (a) Explain the specification for different class of brick. 7
(b) Explain the detail specification of DPC and RCC. 8
5. (a) Explain different types of tool and equipment used in construction. 8
(b) Differentiate between traditional and modular material. 7

Section-C

6. Analysis of rate-for 150mm thick RCC slab in 1:1.5:3 (M20) ratio of slab 10m x 10m. Workout the quantity of dry material, cost of material and cost of RCC work and labor. 15

3701

(3)

3701

7. (a) What do you mean by muster roll? Explain the maintenance of muster roll. 7
(b) Explain the process of preparation of final bill. 8

Section-D

8. (a) Explain in detail contract document. 7
(b) Define contract and also explain type of contract. 8
9. (a) What do you mean by valuation? and explain the purpose of valuation. 7
(b) What do you mean by mortgage lease? and explain different types of mortgage lease. 8

3701