

Roll No.

3701

B. Tech. 8th Semester (Civil Engg.)

Examination – May, 2023

ESTIMATION, COSTING AND VALUATION

Paper : PCC-CE-402-G

Time : Three Hours]

[Maximum Marks : 75

Before answering the questions, candidates should ensure that they have been supplied the correct and complete question paper. No complaint in this regard, will be entertained after examination.

Note : Attempt five questions in all, selecting one question from each Section. Question No. 1 is compulsory. All questions carry equal marks.

1. Describe the following :

2.5 × 6 = 15

(a) Security Money

(b) Cashbook

(c) Retention Money

(d) Depreciation

3701- 1400 -(P-4)(Q-9)(23)

P. T. O.

- (e) Scrap Value and Salvage Value
 (f) Valuation

SECTION - A

2. (a) What do you mean by estimation and also explain different method of estimation? 7
 (b) Explain the process of plastering and pointing. 8
3. Estimate the quantity by the long and short wall method of the following figure: 15

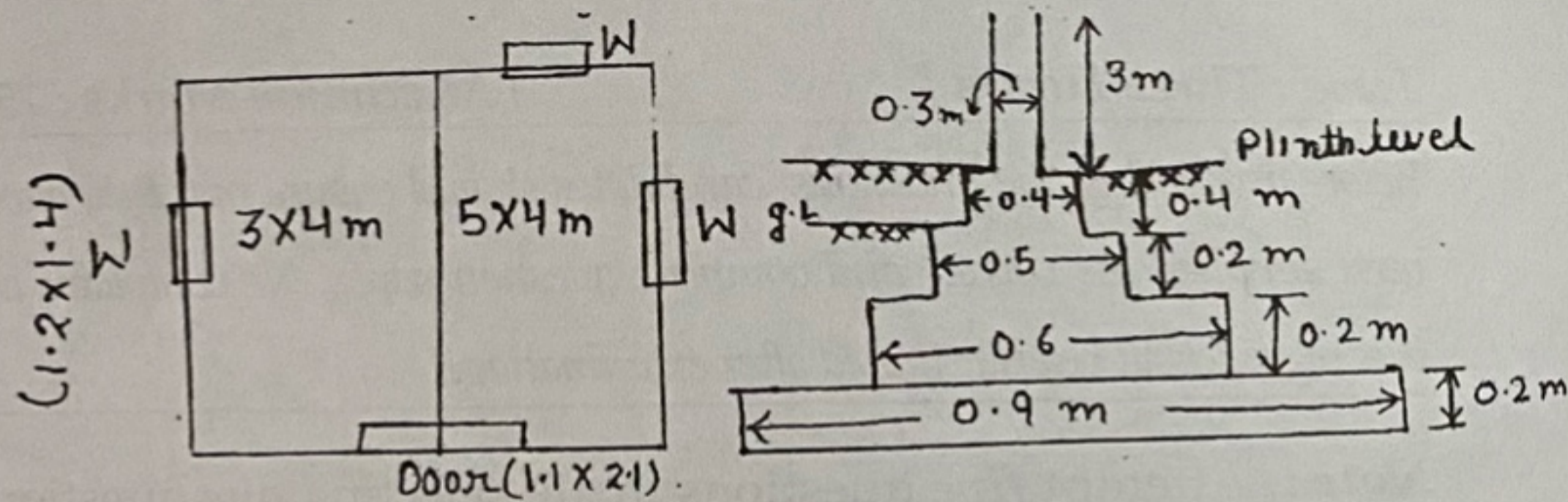

SECTION - B

4. (a) Explain the specification for different class of brick. 7
 (b) Explain the detail specification of Brickwork and Plastering. 8
5. (a) Explain different types of tool and equipment used in construction. 8

- (b) Explain modular material in detail. 7

SECTION - C

6. Workout the quantity of earthwork for an embankment 150 m long and 10 m wide at the top. Side slope is 2 : 1 and depth at each 25 m as follows: 15
 0.6, 1.2, 1.4, 1.6, 1.4, 1.6, 1.5m and length of road is 150 m.
7. (a) What is the procedure to maintain measurement book? 7
 (b) Explain the process of preparation of final bill. 8

SECTION - D

8. (a) Explain what do you mean by tender and its acceptance? 7
 (b) Define contract and also explain type of contract. 8
9. Calculate the standard rent of a government residential building constructed from the following data: 15

Cost of land = Rs. 10,000

Cost of construction of building = Rs. 40,000

Cost of road with in the compound and fencing
= Rs. 2,000

Cost of electric installation including fans = 8% of cost
of building

House tax = Rs. 400 per annum

Water tax = Rs. 250 per annum

Property tax = Rs. 140 per annum

SECTION - D